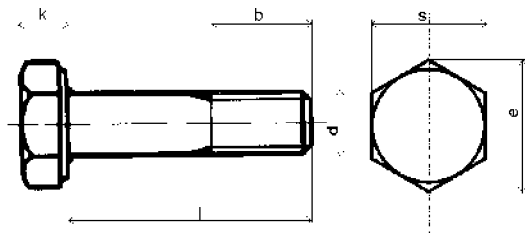

DIN 931
Šrouby se šestihrannou hlavou

ISO : 4014
ČSN : 021101
EN : 24014
Pevnost : 8.8
(10.9)(12.9)

PÚ :

- bez povrch. úpravy
- galvanicky zinkováno
- žár. zinek

| d | M 3 | M 4 | M 5 | M 6 | M 8 | M 10 | M 12 | M 14 | M 16 | M 18 | M 20 | M 22 |
|-------------|------|------|------|-------|-------|------|------|-------|-------|-------|-------|-------|
| b do 120mm | 12 | 14 | 16 | 18 | 22 | 26 | 30 | 34 | 38 | 42 | 46 | 50 |
| b do 200mm | | | 22 | 24 | 28 | 32 | 36 | 40 | 44 | 48 | 52 | 56 |
| b nad 200mm | | | | | | 45 | 49 | 53 | 57 | 61 | 65 | 69 |
| e | 6,01 | 7,66 | 8,79 | 11,05 | 14,38 | 18,9 | 21,1 | 23,91 | 26,17 | 29,56 | 32,95 | 35,03 |
| k | 2 | 2,8 | 3,5 | 4 | 5,3 | 6,4 | 7,5 | 8,8 | 10 | 11,5 | 12,5 | 14 |
| s | 5,5 | 7 | 8 | 10 | 13 | 17 | 19 | 22 | 24 | 27 | 30 | 32 |

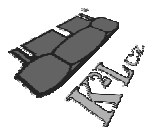
| délka (l) | balení | | | | | | | | | | | |
|-----------|--------|-----|-----|-----|-----|-----|-----|-----|----|----|----|----|
| 25 | | 500 | | | | | | | | | | |
| 30 | 500 | 500 | 500 | 500 | | | | | | | | |
| 35 | 500 | 500 | 200 | 200 | 200 | | | | | | | |
| 40 | 500 | 500 | 200 | 200 | 200 | 100 | | | | | | |
| 45 | 500 | 500 | 200 | 200 | 200 | 100 | 100 | | | | | |
| 50 | | 500 | 200 | 200 | 200 | 100 | 100 | 100 | | | | |
| 55 | | 200 | 200 | 200 | 200 | 100 | 100 | 50 | 50 | 25 | | |
| 60 | | 200 | 200 | 200 | 200 | 100 | 100 | 50 | 50 | 25 | | |
| 65 | | 200 | 200 | 200 | 200 | 100 | 50 | 50 | 25 | 25 | 25 | |
| 70 | | 200 | 200 | 200 | 200 | 100 | 50 | 50 | 25 | 25 | 25 | 25 |
| 75 | | 200 | 200 | 200 | 200 | 100 | 50 | 50 | 25 | 25 | 25 | 25 |
| 80 | | 200 | 200 | 200 | 200 | 100 | 50 | 50 | 25 | 25 | 25 | 25 |
| 85 | | 200 | 200 | 100 | 100 | 100 | 50 | 50 | 25 | 25 | 25 | 25 |
| 90 | | 200 | 200 | 100 | 100 | 100 | 50 | 50 | 25 | 25 | 25 | 25 |
| 95 | | 200 | 200 | 100 | 100 | 100 | 50 | 50 | 25 | 25 | 25 | 25 |
| 100 | | 200 | 200 | 100 | 100 | 100 | 50 | 50 | 25 | 25 | 25 | 10 |
| 105 | | | 200 | 100 | 100 | 50 | 50 | 50 | 25 | 25 | 25 | 10 |
| 110 | | | 200 | 100 | 100 | 50 | 50 | 50 | 25 | 25 | 25 | 10 |
| 115 | | | 200 | 100 | 100 | 50 | 50 | 50 | 25 | 25 | 25 | 10 |
| 120 | | | 200 | 100 | 100 | 50 | 50 | 50 | 25 | 25 | 25 | 10 |
| 125 | | | 200 | 100 | 100 | 50 | 50 | 50 | 25 | 25 | 25 | 10 |
| 130 | | | 200 | 100 | 100 | 50 | 50 | 50 | 25 | 25 | 25 | 10 |
| 135 | | | | 100 | 100 | 50 | 50 | 50 | 25 | 25 | 25 | 10 |



Poznámky :

Dodávky šroubů také v UNC, UNF

Informace o cenách podáváme telefonicky, případně prostřednictvím obchodních zástupců. Rozměry, které nejsou uvedeny v katalogu Vám také rádi sdělíme.

DIN 931
Šrouby se šestihrannou hlavou

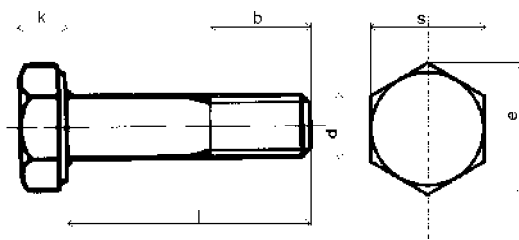
ISO : 4014
ČSN : 021101
EN : 24014
Pevnost : 8.8
 (10.9)(12.9)
PÚ : - bez povrch.
 úpravy
 - galvanicky
 zinkováno
 - žár. zinek



| d | M 3 | M 4 | M 5 | M 6 | M 8 | M 10 | M 12 | M 14 | M 16 | M 18 | M 20 | M 22 |
|-------------|------|------|------|-------|-------|------|------|-------|-------|-------|-------|-------|
| b do 120mm | 12 | 14 | 16 | 18 | 22 | 26 | 30 | 34 | 38 | 42 | 46 | 50 |
| b do 200mm | | | 22 | 24 | 28 | 32 | 36 | 40 | 44 | 48 | 52 | 56 |
| b nad 200mm | | | | | | 45 | 49 | 53 | 57 | 61 | 65 | 69 |
| e | 6,01 | 7,66 | 8,79 | 11,05 | 14,38 | 18,9 | 21,1 | 23,91 | 26,17 | 29,56 | 32,95 | 35,03 |
| k | 2 | 2,8 | 3,5 | 4 | 5,3 | 6,4 | 7,5 | 8,8 | 10 | 11,5 | 12,5 | 14 |
| s | 5,5 | 7 | 8 | 10 | 13 | 17 | 19 | 22 | 24 | 27 | 30 | 32 |

| délka (l) | balení | | | | | | | | | | | |
|-----------|--------|--|-----|-----|-----|----|----|----|----|----|----|----|
| 140 | | | 200 | 100 | 100 | 50 | 50 | 25 | 25 | 25 | 25 | 10 |
| 145 | | | | 100 | 100 | 50 | 50 | 25 | 25 | 25 | 25 | 10 |
| 150 | | | | 100 | 100 | 50 | 50 | 25 | 25 | 25 | 25 | 10 |
| 160 | | | | 100 | 100 | 50 | 25 | 25 | 25 | 25 | 1 | 10 |
| 170 | | | | 100 | 100 | 50 | 25 | 25 | 25 | 25 | 1 | 1 |
| 180 | | | | 100 | 100 | 50 | 25 | 25 | 25 | 25 | 1 | 1 |
| 190 | | | | 100 | 100 | 50 | 25 | 25 | 25 | 1 | 1 | 1 |
| 200 | | | | 100 | 100 | 50 | 25 | 25 | 25 | 1 | 1 | 1 |
| 210 | | | | | 100 | 50 | 25 | 25 | 25 | 1 | 1 | 1 |
| 220 | | | | | 100 | 50 | 25 | 25 | 25 | 1 | 1 | 1 |
| 230 | | | | | 100 | 50 | 25 | 25 | 25 | 1 | 1 | 1 |
| 240 | | | | | 100 | 50 | 25 | 25 | 25 | 1 | 1 | 1 |
| 250 | | | | | 100 | 50 | 25 | 25 | 25 | 1 | 1 | 1 |
| 260 | | | | | 100 | 50 | 25 | 25 | 25 | 1 | 1 | 1 |
| 270 | | | | | 100 | 50 | 25 | 25 | 25 | 1 | 1 | 1 |
| 280 | | | | | 100 | 50 | 25 | 25 | 1 | 1 | 1 | 1 |
| 290 | | | | | 100 | 50 | 25 | 25 | 1 | 1 | 1 | 1 |
| 300 | | | | | 100 | 50 | 25 | 25 | 1 | 1 | 1 | 1 |
| 310 | | | | | | 50 | 25 | 25 | 1 | 1 | 1 | 1 |
| 320 | | | | | | 50 | 25 | 25 | 1 | 1 | 1 | 1 |
| 330 | | | | | | 50 | 25 | | 1 | | 1 | |
| 340 | | | | | | 50 | 25 | 25 | 1 | 1 | 1 | 1 |

Poznámky :

Dodávky šroubů také v UNC, UNF

Informace o cenách podáváme telefonicky, případně prostřednictvím obchodních zástupců. Rozměry, které nejsou uvedeny v katalogu Vám také rádi sdělíme.

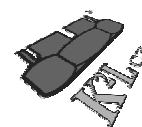

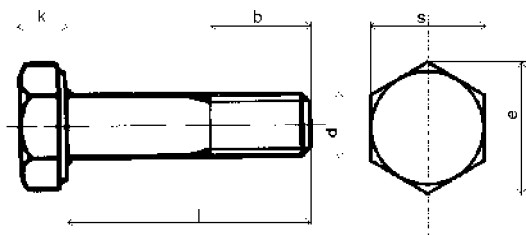
DIN 931
Šrouby se šestihrannou hlavou

ISO : 4014
ČSN : 021101
EN : 24014
Pevnost : 8.8
(10.9)(12.9)

PÚ : - bez povrch.
úpravy

- galvanicky
zinkováno

- žár. zinek

| d | M 3 | M 4 | M 5 | M 6 | M 8 | M 10 | M 12 | M 14 | M 16 | M 18 | M 20 | M 22 |
|-------------|------|------|------|-------|-------|------|------|-------|-------|-------|-------|-------|
| b do 120mm | 12 | 14 | 16 | 18 | 22 | 26 | 30 | 34 | 38 | 42 | 46 | 50 |
| b do 200mm | | | 22 | 24 | 28 | 32 | 36 | 40 | 44 | 48 | 52 | 56 |
| b nad 200mm | | | | | | 45 | 49 | 53 | 57 | 61 | 65 | 69 |
| e | 6,01 | 7,66 | 8,79 | 11,05 | 14,38 | 18,9 | 21,1 | 23,91 | 26,17 | 29,56 | 32,95 | 35,03 |
| k | 2 | 2,8 | 3,5 | 4 | 5,3 | 6,4 | 7,5 | 8,8 | 10 | 11,5 | 12,5 | 14 |
| s | 5,5 | 7 | 8 | 10 | 13 | 17 | 19 | 22 | 24 | 27 | 30 | 32 |

| délka (l) | balení | | | | | | | | | | | |
|-----------|--------|--|--|--|--|----|----|----|---|---|---|---|
| 350 | | | | | | 25 | 25 | 25 | 1 | 1 | 1 | 1 |
| 360 | | | | | | 50 | 25 | 25 | 1 | 1 | 1 | 1 |
| 370 | | | | | | 50 | 25 | 25 | 1 | 1 | 1 | 1 |
| 380 | | | | | | 50 | 25 | 25 | 1 | 1 | 1 | 1 |
| 390 | | | | | | 50 | 25 | 25 | 1 | 1 | 1 | 1 |
| 400 | | | | | | 50 | 25 | 25 | 1 | 1 | 1 | 1 |
| 410 | | | | | | | 25 | 25 | 1 | 1 | 1 | 1 |
| 420 | | | | | | | 25 | 25 | 1 | 1 | 1 | 1 |
| 430 | | | | | | | 25 | 25 | 1 | 1 | 1 | 1 |
| 440 | | | | | | | 25 | 25 | 1 | 1 | 1 | 1 |
| 450 | | | | | | | 25 | 25 | 1 | 1 | 1 | 1 |
| 460 | | | | | | | 25 | 25 | 1 | 1 | 1 | 1 |
| 480 | | | | | | | 25 | 25 | 1 | 1 | 1 | 1 |
| 500 | | | | | | | 25 | 25 | 1 | 1 | 1 | 1 |
| 520 | | | | | | | | | 1 | 1 | 1 | |
| 540 | | | | | | | | | 1 | | 1 | |
| 560 | | | | | | | | | 1 | | 1 | |
| 580 | | | | | | | | | 1 | | 1 | |
| 600 | | | | | | | | | 1 | | 1 | |
| 620 | | | | | | | | | 1 | | 1 | |
| 640 | | | | | | | | | 1 | | 1 | |
| 660 | | | | | | | | | | | 1 | |

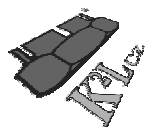

Poznámky :

Dodávky šroubů také v UNC, UNF

Informace o cenách podáváme telefonicky, případně prostřednictvím obchodních zástupců. Rozměry, které nejsou uvedeny v katalogu Vám také rádi sdělíme.

Šrouby se šestihrannou hlavou

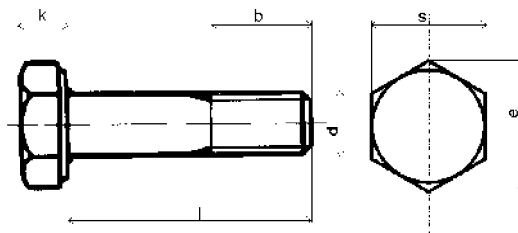
ISO : 4014
ČSN : 021101
EN : 24014
Pevnost : 8.8
 (10.9)(12.9)
PÚ : - bez povrch.
 úpravy
 - galvanicky
 zinkováno
 - žár. zinek



| d | M 24 | M 27 | M 30 | M 33 | M 36 | M 39 | M 42 | M 45 | M 48 | M 52 | M 56 | M 64 |
|-------------|-------|------|-------|-------|-------|-------|------|------|------|------|-------|------|
| b do 120mm | 54 | 60 | 66 | 72 | 78 | 84 | 90 | | 102 | | | |
| b do 200mm | 60 | 66 | 72 | 78 | 84 | 90 | 96 | | 108 | | 124 | |
| b nad 200mm | 73 | 79 | 85 | 91 | 97 | 103 | 109 | | 121 | | 137 | |
| e | 39,55 | 45,2 | 50,85 | 55,37 | 60,79 | 66,44 | 71,3 | | 82,6 | | 93,56 | |
| k | 15 | 17 | 18,7 | 21 | 22,5 | 25 | 26 | | 30 | | 35 | |
| s | 36 | 41 | 46 | 50 | 55 | 60 | 65 | | 75 | | 85 | |

| délka (l) | balení | | | | | | | | | | | |
|-----------|--------|----|---|---|---|---|---|---|---|---|---|---|
| 75 | 25 | 10 | | | | | | | | | | |
| 80 | 25 | 10 | 1 | | | | | | | | | |
| 85 | 10 | 10 | 1 | | | | | | | | | |
| 90 | 10 | 10 | 1 | 1 | | | | | | | | |
| 95 | 10 | 10 | 1 | 1 | | | | | | | | |
| 100 | 10 | 10 | 1 | 1 | 1 | | | | | | | |
| 105 | 10 | 10 | 1 | 1 | 1 | | | | | | | |
| 110 | 10 | 1 | 1 | 1 | 1 | 1 | | | | | | |
| 115 | 10 | 1 | 1 | 1 | 1 | 1 | | | | | | |
| 120 | 10 | 1 | 1 | 1 | 1 | 1 | 1 | 1 | | | | |
| 125 | 10 | 1 | 1 | 1 | 1 | 1 | 1 | 1 | | | | |
| 130 | 10 | 1 | 1 | 1 | 1 | 1 | 1 | 1 | 1 | 1 | 1 | |
| 135 | 10 | 1 | 1 | 1 | 1 | 1 | 1 | 1 | 1 | 1 | 1 | |
| 140 | 10 | 1 | 1 | 1 | 1 | 1 | 1 | 1 | 1 | 1 | 1 | |
| 145 | 10 | 1 | 1 | 1 | 1 | 1 | 1 | 1 | 1 | 1 | 1 | |
| 150 | 10 | 1 | 1 | 1 | 1 | 1 | 1 | 1 | 1 | 1 | 1 | |
| 160 | 10 | 1 | 1 | 1 | 1 | 1 | 1 | 1 | 1 | 1 | 1 | |
| 170 | 1 | 1 | 1 | 1 | 1 | 1 | 1 | 1 | 1 | 1 | 1 | |
| 180 | 1 | 1 | 1 | 1 | 1 | 1 | 1 | 1 | 1 | 1 | 1 | |
| 190 | 1 | 1 | 1 | 1 | 1 | 1 | 1 | 1 | 1 | 1 | 1 | |
| 200 | 1 | 1 | 1 | 1 | 1 | 1 | 1 | 1 | 1 | 1 | 1 | 1 |
| 210 | 1 | 1 | 1 | 1 | 1 | 1 | 1 | 1 | 1 | 1 | 1 | 1 |
| 220 | 1 | 1 | 1 | 1 | 1 | 1 | 1 | 1 | 1 | 1 | 1 | 1 |
| 230 | 1 | 1 | 1 | 1 | 1 | 1 | 1 | 1 | 1 | 1 | 1 | 1 |

Poznámky :

Dodávky šroubů také v UNC, UNF

Informace o cenách podáváme telefonicky, případně prostřednictvím obchodních zástupců. Rozměry, které nejsou uvedeny v katalogu Vám také rádi sdělíme.

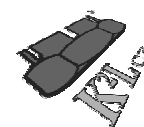

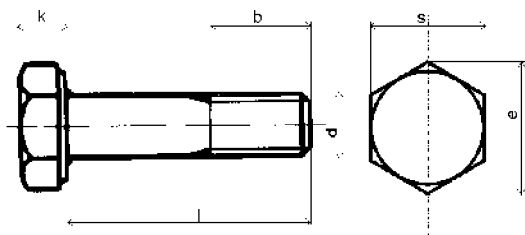
DIN 931
Šrouby se šestihrannou hlavou

ISO : 4014
ČSN : 021101
EN : 24014
Pevnost : 8.8
(10.9)(12.9)

PÚ : - bez povrch.
úpravy

- galvanicky
zinkováno

- žár. zinek

| d | M 24 | M 27 | M 30 | M 33 | M 36 | M 39 | M 42 | M 45 | M 48 | M 52 | M 56 | M 64 |
|-------------|-------|------|-------|-------|-------|-------|------|------|------|------|-------|------|
| b do 120mm | 54 | 60 | 66 | 72 | 78 | 84 | 90 | | 102 | | | |
| b do 200mm | 60 | 66 | 72 | 78 | 84 | 90 | 96 | | 108 | | 124 | |
| b nad 200mm | 73 | 79 | 85 | 91 | 97 | 103 | 109 | | 121 | | 137 | |
| e | 39,55 | 45,2 | 50,85 | 55,37 | 60,79 | 66,44 | 71,3 | | 82,6 | | 93,56 | |
| k | 15 | 17 | 18,7 | 21 | 22,5 | 25 | 26 | | 30 | | 35 | |
| s | 36 | 41 | 46 | 50 | 55 | 60 | 65 | | 75 | | 85 | |

| délka (l) | balení | | | | | | | | | | | |
|-----------|--------|---|---|---|---|---|---|---|---|---|---|---|
| 240 | 1 | 1 | 1 | 1 | 1 | 1 | 1 | 1 | 1 | 1 | 1 | 1 |
| 250 | 1 | 1 | 1 | 1 | 1 | 1 | 1 | 1 | 1 | 1 | 1 | 1 |
| 260 | 1 | 1 | 1 | 1 | 1 | 1 | 1 | 1 | 1 | 1 | 1 | 1 |
| 270 | 1 | 1 | 1 | 1 | 1 | 1 | 1 | 1 | 1 | 1 | 1 | 1 |
| 280 | 1 | 1 | 1 | 1 | 1 | 1 | 1 | 1 | 1 | 1 | 1 | 1 |
| 290 | 1 | 1 | 1 | 1 | 1 | 1 | 1 | 1 | 1 | 1 | 1 | 1 |
| 300 | 1 | 1 | 1 | 1 | 1 | 1 | 1 | 1 | 1 | 1 | 1 | 1 |
| 310 | 1 | 1 | 1 | 1 | 1 | 1 | 1 | 1 | 1 | 1 | 1 | 1 |
| 320 | 1 | 1 | 1 | 1 | 1 | 1 | 1 | 1 | 1 | 1 | 1 | 1 |
| 330 | 1 | 1 | 1 | 1 | 1 | 1 | 1 | 1 | 1 | 1 | 1 | 1 |
| 340 | 1 | 1 | 1 | 1 | 1 | 1 | 1 | 1 | 1 | 1 | 1 | 1 |
| 350 | 1 | 1 | 1 | 1 | 1 | 1 | 1 | 1 | 1 | 1 | 1 | 1 |
| 360 | 1 | 1 | 1 | 1 | 1 | 1 | 1 | 1 | 1 | 1 | 1 | 1 |
| 370 | 1 | 1 | 1 | 1 | 1 | 1 | 1 | 1 | 1 | 1 | 1 | 1 |
| 380 | 1 | 1 | 1 | 1 | 1 | 1 | 1 | 1 | 1 | 1 | 1 | 1 |
| 390 | 1 | 1 | 1 | 1 | 1 | 1 | 1 | 1 | 1 | 1 | 1 | 1 |
| 400 | 1 | 1 | 1 | 1 | 1 | 1 | 1 | 1 | 1 | 1 | 1 | 1 |
| 410 | 1 | 1 | 1 | 1 | 1 | 1 | 1 | 1 | 1 | 1 | 1 | 1 |
| 420 | 1 | 1 | 1 | 1 | 1 | 1 | 1 | 1 | 1 | 1 | 1 | 1 |
| 430 | 1 | 1 | 1 | 1 | 1 | 1 | 1 | 1 | 1 | 1 | 1 | 1 |
| 440 | 1 | 1 | 1 | 1 | 1 | 1 | 1 | 1 | 1 | 1 | 1 | 1 |
| 450 | 1 | 1 | 1 | 1 | 1 | 1 | 1 | 1 | 1 | 1 | 1 | 1 |
| 460 | 1 | 1 | 1 | 1 | 1 | 1 | 1 | 1 | 1 | 1 | 1 | 1 |
| 480 | 1 | 1 | 1 | 1 | 1 | 1 | 1 | 1 | 1 | 1 | 1 | 1 |

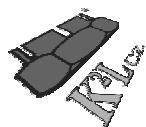

Poznámky :

Dodávky šroubů také v UNC, UNF

Informace o cenách podáváme telefonicky, případně prostřednictvím obchodních zástupců. Rozměry, které nejsou uvedeny v katalogu Vám také rádi sdělíme.

Šrouby se šestihrannou hlavou

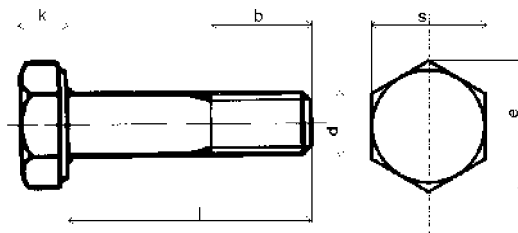
ISO : 4014
ČSN : 021101
EN : 24014
Pevnost : 8.8
 (10.9)(12.9)
PÚ : - bez povrch.
 úpravy
 - galvanicky
 zinkováno
 - žár. zinek



| d | M 24 | M 27 | M 30 | M 33 | M 36 | M 39 | M 42 | M 45 | M 48 | M 52 | M 56 | M 64 |
|-------------|-------|------|-------|-------|-------|-------|------|------|------|------|-------|------|
| b do 120mm | 54 | 60 | 66 | 72 | 78 | 84 | 90 | | 102 | | | |
| b do 200mm | 60 | 66 | 72 | 78 | 84 | 90 | 96 | | 108 | | 124 | |
| b nad 200mm | 73 | 79 | 85 | 91 | 97 | 103 | 109 | | 121 | | 137 | |
| e | 39,55 | 45,2 | 50,85 | 55,37 | 60,79 | 66,44 | 71,3 | | 82,6 | | 93,56 | |
| k | 15 | 17 | 18,7 | 21 | 22,5 | 25 | 26 | | 30 | | 35 | |
| s | 36 | 41 | 46 | 50 | 55 | 60 | 65 | | 75 | | 85 | |

| délka (l) | balení | | | | | | | | | | | |
|-----------|--------|---|---|---|---|---|---|---|---|---|---|---|
| 500 | 1 | 1 | 1 | 1 | 1 | 1 | 1 | 1 | 1 | 1 | 1 | 1 |
| 520 | 1 | 1 | 1 | 1 | 1 | 1 | 1 | 1 | 1 | 1 | 1 | 1 |
| 540 | 1 | 1 | 1 | 1 | 1 | 1 | 1 | 1 | 1 | 1 | 1 | 1 |
| 560 | 1 | 1 | 1 | 1 | 1 | 1 | 1 | 1 | 1 | 1 | 1 | 1 |
| 580 | 1 | | 1 | | 1 | 1 | 1 | | 1 | | | |
| 600 | 1 | | 1 | | 1 | | 1 | | 1 | | | |
| 620 | 1 | | 1 | | 1 | | 1 | | 1 | | | |
| 640 | 1 | | 1 | | 1 | | 1 | | 1 | | | |
| 660 | 1 | | 1 | | 1 | | | | 1 | | | |
| 680 | 1 | | 1 | | 1 | | | | 1 | | | |
| 700 | | | 1 | | 1 | | | | 1 | | | |
| 720 | | | 1 | | 1 | | | | 1 | | | |
| 740 | | | 1 | | 1 | | | | 1 | | | |
| 760 | | | | | 1 | | | | 1 | | | |
| 780 | | | | | 1 | | | | 1 | | | |
| 800 | | | | | 1 | | | | 1 | | | |
| 820 | | | | | 1 | | | | 1 | | | |
| 840 | | | | | 1 | | | | 1 | | | |
| 860 | | | | | 1 | | | | 1 | | | |
| 880 | | | | | 1 | | | | 1 | | | |
| 900 | | | | | 1 | | | | | | | |
| 920 | | | | | 1 | | | | | | | |
| 940 | | | | | 1 | | | | | | | |
| 950 | | | | | 1 | | | | | | | |

Poznámky :

Dodávky šroubů také v UNC, UNF

Informace o cenách podáváme telefonicky, případně prostřednictvím obchodních zástupců. Rozměry, které nejsou uvedeny v katalogu Vám také rádi sdělíme.

